

110031S VOLANTE ROMA

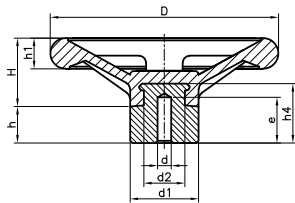

| Código | D | H | d | e | d2 | h4 | d1 | h | h1 | Color |
|--------------|-----|----|------|----|----|----|----|----|------|-------|
| 11003110601 | 100 | 31 | 5,25 | 20 | 22 | 26 | 30 | 16 | 13,5 | Negro |
| 11003112601 | 125 | 37 | 8 | 25 | 28 | 32 | 40 | 22 | 14 | Negro |
| 11003115601* | 150 | 50 | 10 | 30 | 30 | 55 | 50 | 30 | 18 | Negro |
| 11003117601 | 175 | 51 | 10 | 30 | 30 | 55 | 50 | 30 | 20 | Negro |
| 11003120601 | 200 | 70 | 10 | 30 | 30 | 55 | 50 | 30 | 26 | Negro |
| 11003130601* | 300 | 98 | 10 | 30 | 34 | 60 | 60 | 18 | 30 | Negro |

(*) 5 radios

Núcleo de hierro tratado.
PF: Resina fenólica negra FS 31 DIN 7708.